

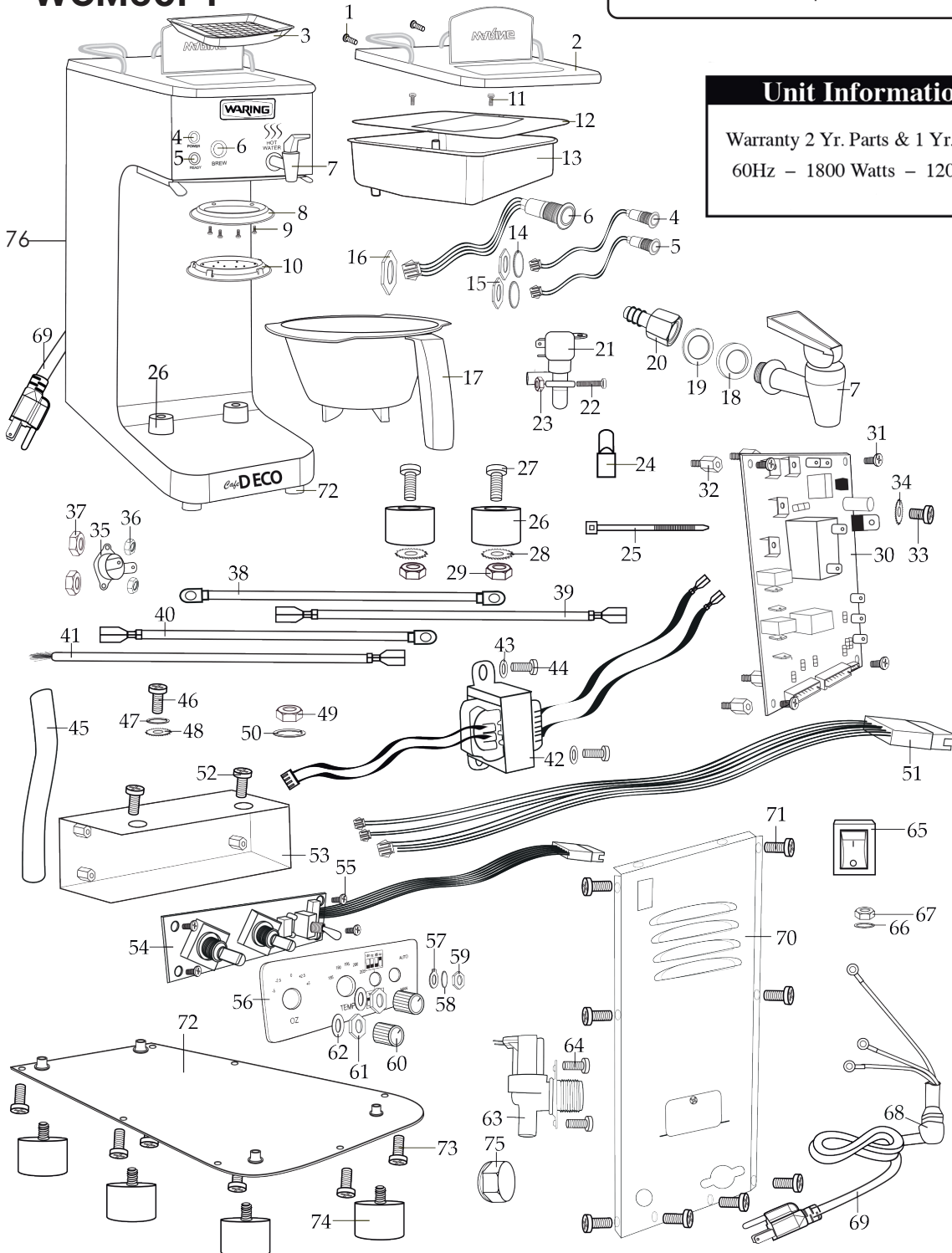

Automatic Thermal Coffee Brewer

WCM60PT



Unit Information

This high-performance commercial kitchen essential is a must for satisfying high demand for fresh-brewed coffee. Designed for easy operation with a plumbing connection, it offers a built-in pour-over feature and an easy-draw faucet that provides hot water on demand for soups and hot beverages.

Unit Information

Warranty 2 Yr. Parts & 1 Yr. Labor
60Hz - 1800 Watts - 120 Volts

Illustration #	Part #	Description
1	037166	Screw (2 required Per unit)
2	038120	Top Plate
3	038073	Plastic Net
4	038112	Power On Red Light
5	038007	Ready Green Light
6	038110	Brew Light
7	037988	Tap (spigot)
8	038072	Spreader Holder
9	038076	Screw (4 required Per unit)
10	038044	Spreader
11	038076	Screw (2 required Per unit)
12	038090	Basin Cover
13	038089	Basin
14	038084	Lock Washer (power light & ready light)
15	016236	Hex Nut power light & ready light)
16	038008	Hex Nut (brew light)
17	038018	Brew Basket
18	037990	Metal Washer
19	037989	Rubber Washer
20	037991	Tap Hose Adapter
21	037996	Brew Solenoid
22	037997	Screw (2 required Per unit)
23	037171	Hex Nut (2 required Per unit)
24	019123	Crimp Connector (2 required Per unit)
25	013731	Wire Nut (10 required Per unit)
26	038003	Rubber Stopper (2 required Per unit)
27	038004	Screw (1 for each stopper)
28	037175	Lock Washer (1 for each stopper)
29	037174	Hex Nut (1 for each stopper)



Illustration #	Part #	Description
30	037987	PCB Board
31	038010	Plastic Screw (4 required Per unit)
32	038011	Plastic Connector (4 required Per unit)
33	037161	Screw (for PCB Board)
34	037158	Lock Washer (for PCB Board)
35	037153	Thermal Cut Off
36	037154	Hex Nut (2 required Per unit)
37	037171	Hex Nut (2 required Per unit)
38a	038083	8.5" Yellow/Green Lead (with 2 ring terminal)
38b	037973	6.75" Burgundy Lead (with 2 ring terminal)
38c	037974	6.75" Blue Lead (with 2 ring terminal)
39a	037984	12.25" Burgundy Lead (with 2 straight terminal)
39b	038098	12.5" Burgundy Lead (with 2 straight terminal)
39c	038097	12.5" Blue Lead (with 2 straight terminal)
39d	037980	28.5" Burgundy Lead (with 2 straight terminal)
39e	037981	28.5" Blue Lead (with 2 straight terminal)
40a	038077	4.75" Burgundy Lead (with 1 ring + 1 straight terminal)
40b	037976	8.5" Yellow/Green Lead (with 1 ring + 1 straight terminal)
40c	037979	8.75" Black Lead (2 required) (with 1 ring + 1 straight terminal)
40d	037977	12.75" Blue Lead (with 1 ring + 1 straight terminal)
41a	038099	12" Blue Lead (with 1 straight terminal)
41b	038100	12" Burgundy Lead (with 1 straight terminal)
42	037708	Transformer
43	038104	Washer (2 required Per unit)
44	037166	Screw (2 required Per unit)
45a	037999	2" Hose
45b	038106	3.75" Hose
45c	038000	5.25" Hose
45d	037771	7" Hose



Illustration #	Part #	Description
45e	038107	9" Hose
45f	038108	10.25" Hose
45g	038070	12.5" Hose
46	037166	Screw (for ground top of unit)
47	038085	Spring Washer (for ground top of unit)
48	037158	Lock Washer (for ground top of unit)
49	038102	Hex Nut (black lead to pcb board)
50	038103	Spring Washer (black lead to pcb board)
51	037992	Lead Tape with Black Sleeve
52	037166	Screw (2 required Per unit)
53	038094	Temperature Board Holder with Connectors
54	038016	Temperature Board
55	038010	Plastic Screw (4 required Per unit)
56	038012	Temperature Board Cover
57	038093	Washer (auto - man shaft)
58	038092	Lock Washer (auto - man shaft)
59	038091	Hex Nut (auto - man shaft)
60	038013	Knob (2 required Per unit)
61	038015	Hex Nut (1 under each knob)
62	038014	Washer (1 under each knob)
63	037165	Water Fill Solenoid
64	037166	Screw (2 required Per unit)
65	038017	Rocker Switch
66	038085	Spring Washer (for ground bottom of unit)
67	037171	Hex Nut (for ground bottom of unit)
68	038101	Back Plate
69	037166	Screw (8 required Per unit)
70	037172	Strain Relief
71	037173	Power Cord

Illustration #	Part #	Description
72	037995	Bottom Plate
73	037166	Screw (7 required Per unit)
74	037705	Yellow Valve Cover
75	038020	Package of Filters
76	038134	WCM60PT Base Unit (No Basket)



TORRINGTON, CT 06790
 AUTOMATIC COFFEE BREWER/
 CAFETIÈRE COMMERCIALE À REMPLISSAGE AUTOMATIQUE
 MODEL / MODÈLE: WCM60PT
 120VAC 60Hz 1660W
 MADE IN CHINA / FABRIQUÉ EN CHINE
 APPROVED FOR COMMERCIAL USE /
 USAGE COMMERCIAL AUTORISÉ
CAUTION: DO NOT IMMERSE IN LIQUID /
ATTENTION: NE PAS PLONGER DANS L'EAU

Date Code Location → D/C: WWYY
 (week week year year)